

## 1/4" Swagelok type cell: two electrodes

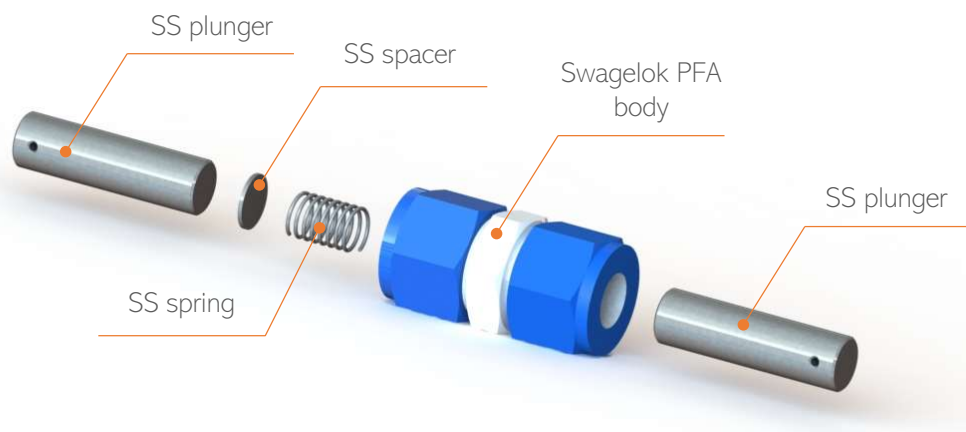

### Specification

Component	Material	Dimensions
Plungers	Stainless steel SS316L	Ø 6.35 mm x 45 mm
Spring	Stainless steel SS316L	Ex Ø 6.1 mm x 11 mm
Spacer	Stainless steel SS316L	Ø 6 mm x 3 mm
Body	PFA	--

\* Cells with SS316L body require Mylar electrical insulation film

### Cell dimensions

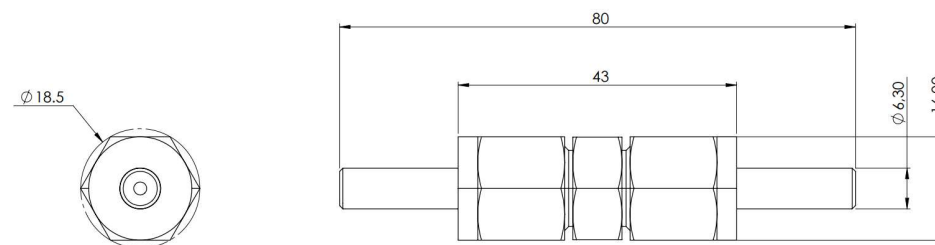

### Features

- Compact design
- Quality materials (stainless steel 316, PTFE)
- Ease of assembly and disassembly
- Easy recovery of electrodes after experiments
- Easy component cleaning

